

# Lady Gowrie Qld Conference 2016

## Belonging: Connecting with Children, Families and our Communities

### EXHIBITOR DISPLAY PRODUCT TABLE

#### **Belonging: Connecting with Children, Families and our Communities**

The Gowrie Qld is delighted to be able to offer exhibitor opportunities at the 2016 Conference. Our Conference this year will be held at the RNA and we are looking to host 500 delegates from around Queensland at the event.

Our guest speakers this year will be Michael Crossland and Alison Hill as well as many other workshop presenters.

<b>Cost</b>	\$300
<b>Registration</b>	Complimentary registration
<b>Exhibition</b>	Catering for Morning Tea, Lunch and Cocktail Reception
<b>Size</b>	3m x 3m
<b>Furniture</b>	2 x Chairs 1 x 1.8m trestle table
<b>Power</b>	1 x Power point

Prices for additional equipment

Chair: \$ 10.00

Trestle Table: \$15.00 each

Power: \$15.00 each

#### **ADDITIONAL FEATURES**

For additional furniture options and a price list, contact the recommended suppliers

Moreton Hire:

Bridget Egan

Ph: (07) 3010 4360

Email: [bridget.egan@moreton.net.au](mailto:bridget.egan@moreton.net.au)

Website: [www.moreton.net.au](http://www.moreton.net.au)



# Lady Gowrie Qld Conference 9<sup>th</sup> April 2016

## REGISTRATIONS

Each Exhibitor display booking will include:

- Name badge
- Attendance at conference sessions
- Attendance at the Welcome and Closing Address
- Morning Tea, Lunch and Cocktail Reception

## ACCESS TO THE EXHIBITION AREA

Exhibitors will have access to the Exhibition Hall from 7.00 am Saturday 9<sup>th</sup> April 2016.

At the conclusion of the conference, displays should be dismantled by 6:00pm.

There is no available storage space at the venue so exhibitor equipment may not be held.

The Loading dock Supervisor details:

Gavin Simpson

(07) 3253 5123

Email: [gsimpson@rna.org.au](mailto:gsimpson@rna.org.au)

Entry to the loading dock is via Gregory Terrace, Bowen Hills, Queensland 4006. Goods will not be accepted at any other location. It is the senders' responsibility to ensure the delivery address and recipient details are clearly stated and upon parcel drop off, a clear signature is obtained from a Royal ICC loading dock representative.

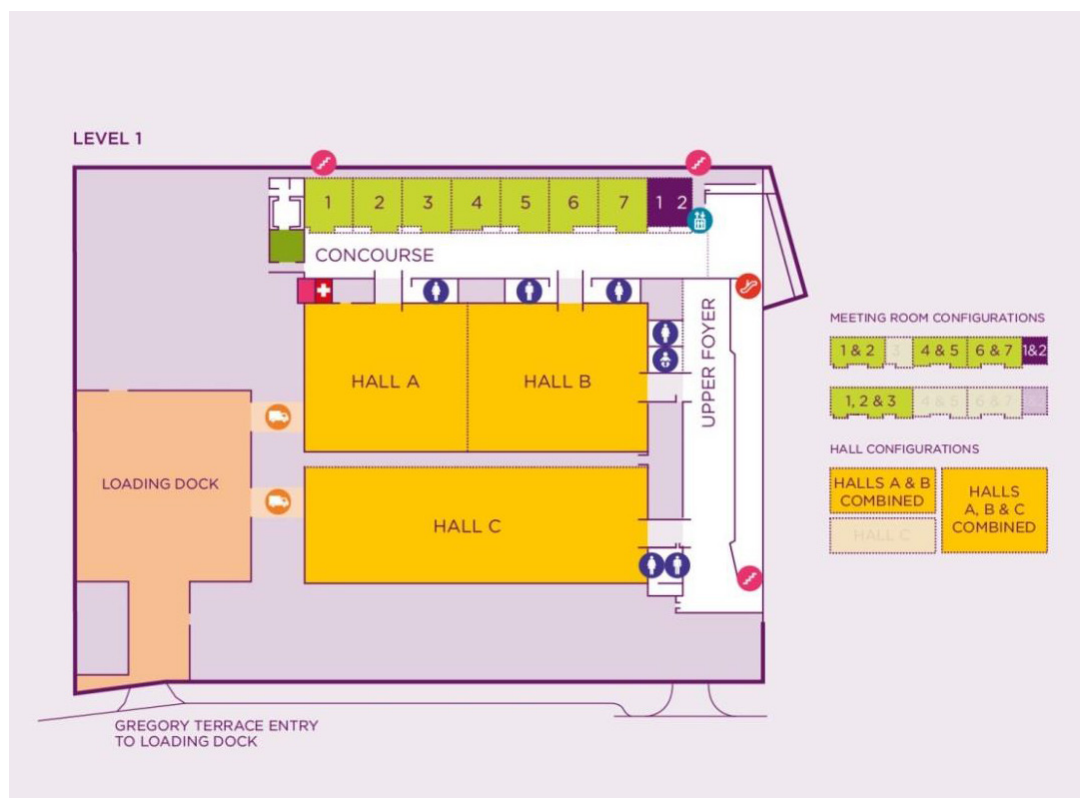

## Exhibitor Form

Name of Exhibitor/s: \_\_\_\_\_

Company: \_\_\_\_\_

Will you have a banner (Free standing only)? Yes / NO

Please tick the number of the following you will require:

Chairs:       2       3       4       5

Tables:       1       2       3       4       5

Power Points:       1       2       3       4       5

Other:

---

---

---

If you have any queries regarding the Exhibitor Display Tables, please do not hesitate to contact Brooke Kelly on (07) 3252 2667 or [events@ladygowrie.com.au](mailto:events@ladygowrie.com.au).

Please complete and return to Brooke Kelly at [events@ladygowrie.com.au](mailto:events@ladygowrie.com.au) by Friday 25<sup>th</sup> March 2016.

